

**ROAD CROSS SECTION WITH FILTER DRAIN**  
SCALE 1:50

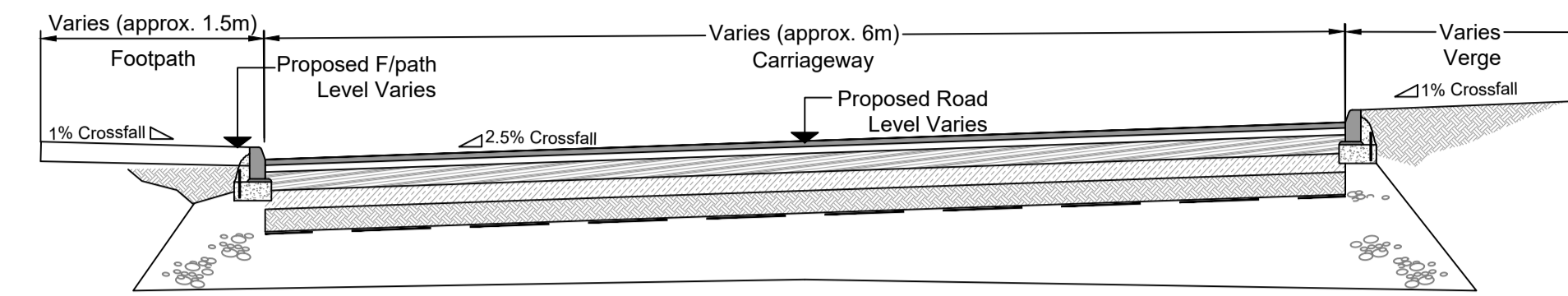

**ROAD CROSS-SECTION**  
SCALE 1:50

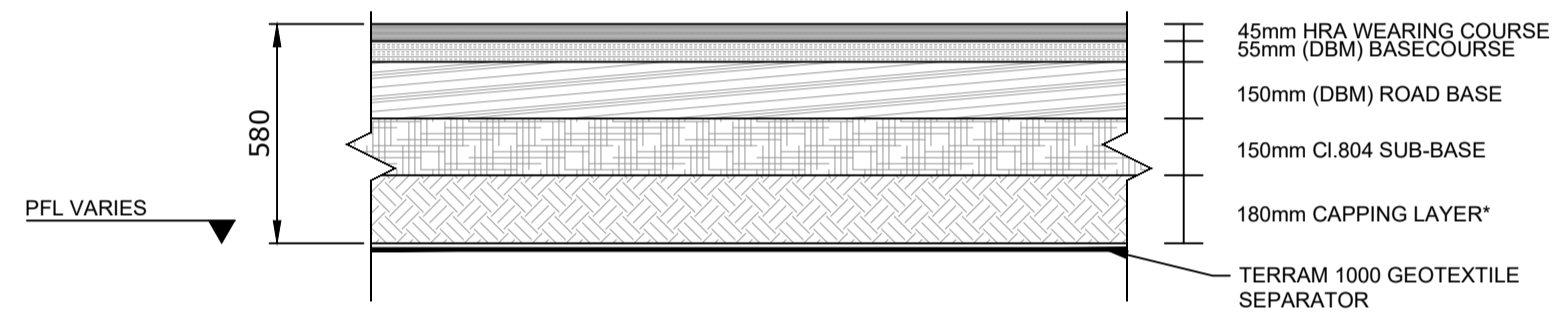

**A ROAD CONSTRUCTION**  
SCALE 1:20

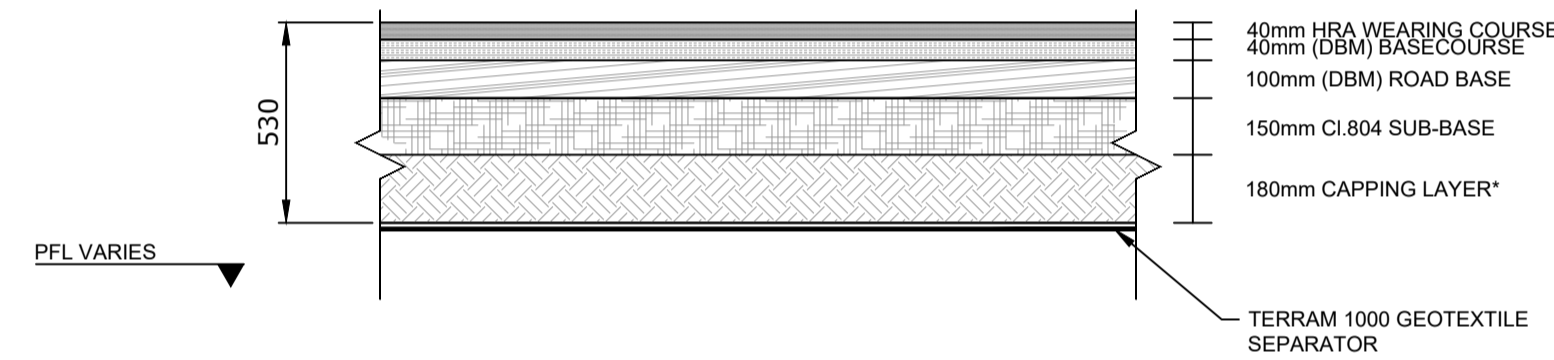

**B CARPARK CONSTRUCTION**  
SCALE 1:20

\*NOTE: CAPPING LAYER IS DEPENDENT ON CBR TESTS.

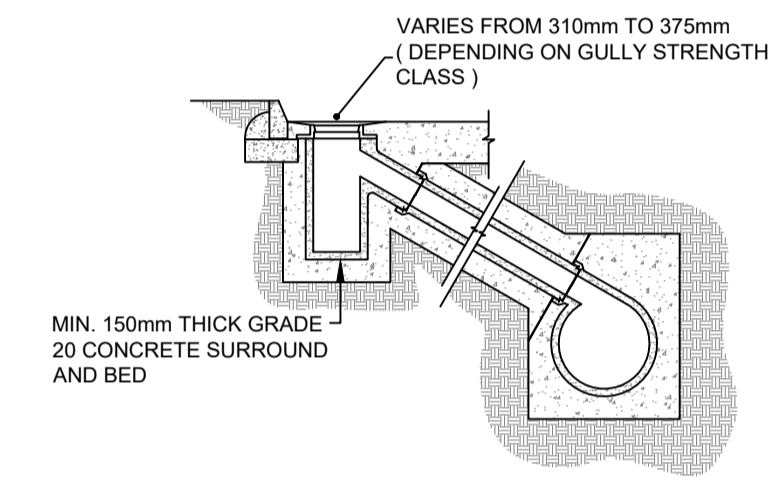

NOTE 1 : TRAPPED GULLIES TO BE USED WHERE CONNECTED TO A COMBINED SEWER  
NOTE 2 : FOR STRENGTH CLASS OF GULLY REFER TO EN 124 : 1994, CLAUSE 5

**C GULLY CONSTRUCTION**  
SCALE 1:20

**NOTES :**

- FIGURED DIMENSIONS ONLY TO BE TAKEN FROM THIS DRAWING.
- ALL DRAWINGS TO BE CHECKED BY THE CONTRACTOR ON SITE
- ENGINEER/EMPLOYERS REPRESENTATIVE, AS APPROPRIATE, TO BE INFORMED BY THE CONTRACTOR OF ANY DISCREPANCIES BEFORE ANY WORK COMMENCES
- THE CONTRACTOR SHALL UNDERTAKE A THOROUGH CHECK FOR THE ACTUAL LOCATION OF ALL SERVICES/UTILITIES, ABOVE AND BELOW GROUND, BEFORE ANY WORK COMMENCES
- ALL LEVELS SHOWN RELATE TO ORDNANCE SURVEY DATUM AT MALIN HEAD

Rev	Date	Description	By	Chkd.
A	26.04.23	PLANNING ISSUE	MN	RH

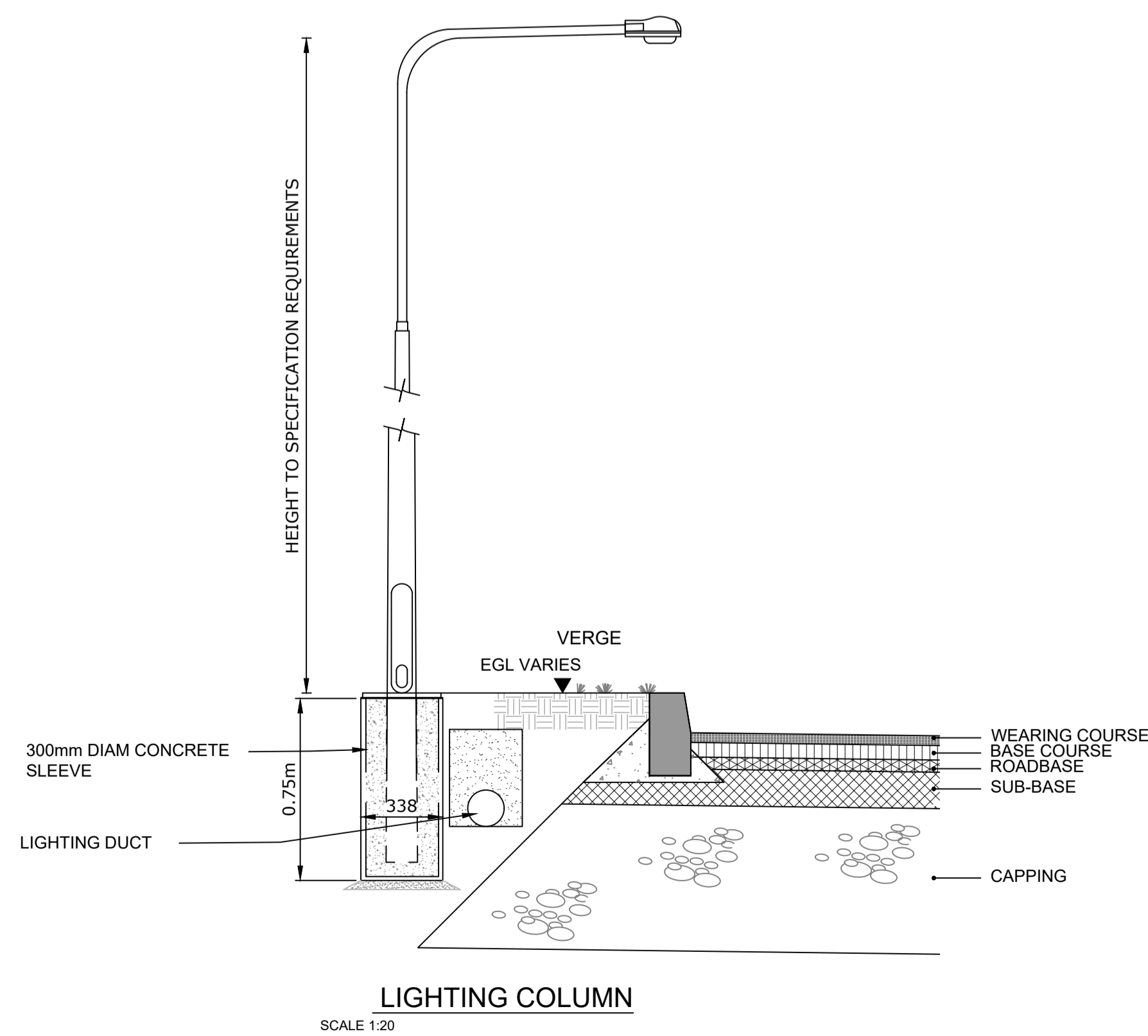

**LIGHTING COLUMN**  
SCALE 1:20

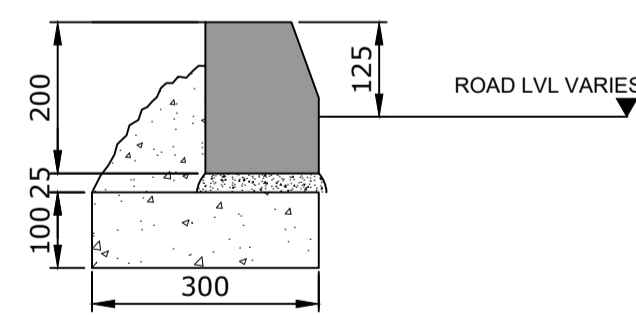

**TYPE 2 - EDGE RESTRAINT**  
**CARPARK/LIGHT VEHICLES**

**EDGE RESTRAINT DETAILS**  
SCALE 1:10

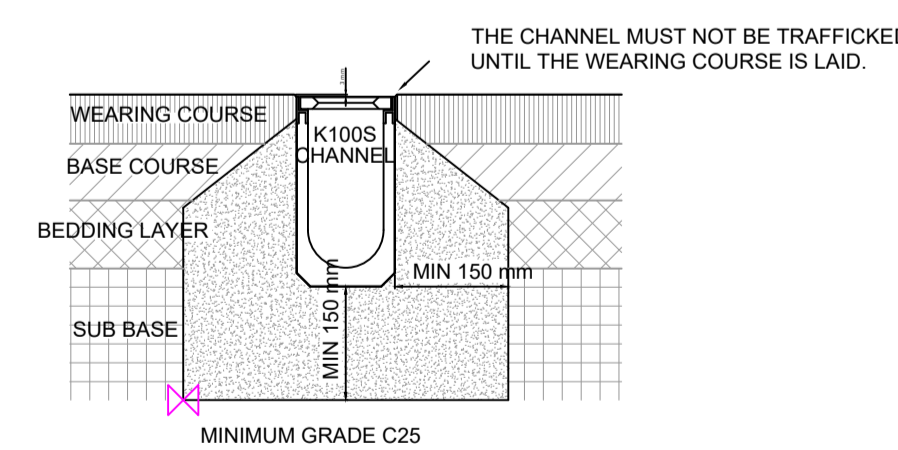

**INSTALLATION EXAMPLE**  
**FLEXIBLE PAVEMENT**  
SCALE 1:10

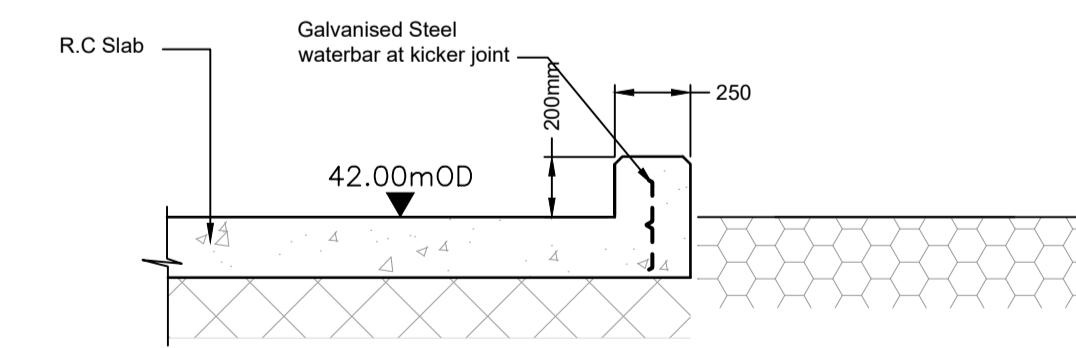

**BUND WALL DETAIL SURROUNDING**  
**HARDSTAND & SRF STORAGE AREA**  
Scale 1:25

Client:  
**Bord na Móna**

Project:  
**DREHID WASTE MANAGEMENT FACILITY FURTHER DEVELOPMENT**

Title:  
**CAR PARK & ROAD CONSTRUCTION DETAILS**

Scale @ A1: **As Shown**  
Prepared by: **M. Nolan** Checked: **R. Hunt** Date: **November 22**  
Project Director: **S. Tinnelly**  
Drawing Status: **Planning**

**TOBIN**  
CONSULTING ENGINEERS  
Block 10-4, Blanchardstown Corporate Park,  
Dublin 15, Ireland.  
tel: +353-(0)1-8030406  
fax: +353-(0)1-8030409  
e-mail: dublin@tobin.ie  
www.tobin.ie

Tobin Consulting Engineers will not be liable for any use of this document for any purpose other than that for which it was originally prepared and provided. Except where specifically mentioned, all rights are reserved by Tobin Consulting Engineers, who copyright holder, in part of this document. No part of this document may be reproduced or transmitted in any form and this document shall not be relied upon by any third party for any purpose.  
Drawing No.: **11290-2051** Revision: **A**